

13

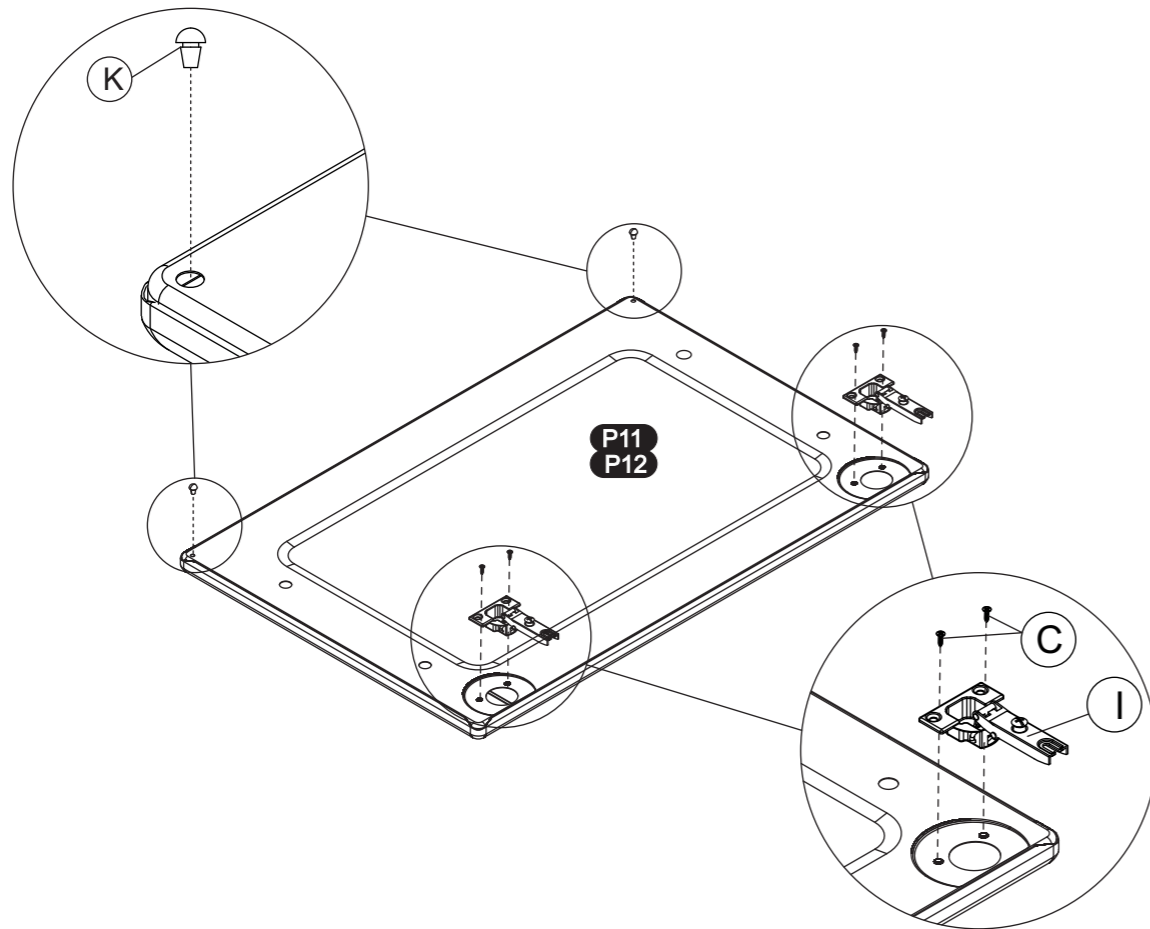

ATENÇÃO:
 -Ler e observar atentamente toda a instrução antes de iniciar a montagem.
 -Monte o móvel sobre uma forração, de preferência em cima de uma mesa.
 -Somente aperte os Parafusos após a montagem do móvel.
 -Observe que nas Laterais existe uma etiqueta de indicação.
ATTENTION:
 -Read the instructions carefully before starting the assembly
 -Assemble the cabinet on a carpet on top of a table if possible.
 -Fasten the screws only after the cabinet complete assembling.
 -Observe that there is an indication label on the side units.
ATENCIÓN:
 -Lea y fíjese atentamente en la esquemática de la ensamblaje, antes de armar el mueble
 -Arme el mueble sobre una superficie protegida, de preferencia arriba de una mesa.
 -Solamente apriete los Tornillos después del ensamblaje del mueble.
 -Fíjese que en la lateral existe una etiqueta que indica la dirección

Bertolini
 Armário Triplo 1050/1200
 Triple Cabinet 1050/1200
 Armário Triple 1050/1200

- P51 Lateral /Side Panel/Lateral
- P30 Base Menor/Minor Upper panel/Base Menor
- P29 Base Maior/ Large Upper panel/Base Mayor
- P56 Fundo /Bottom/Fondo
- P12 Porta Direita /Right Door/Puerta Derecha
- P11 Porta Esquerda /Left Door/Puerta Izquierda
- P57 Coluneta /Column/Vigueta

Quantidade Quantity Cantidad
02
01
02
01
02
01
01

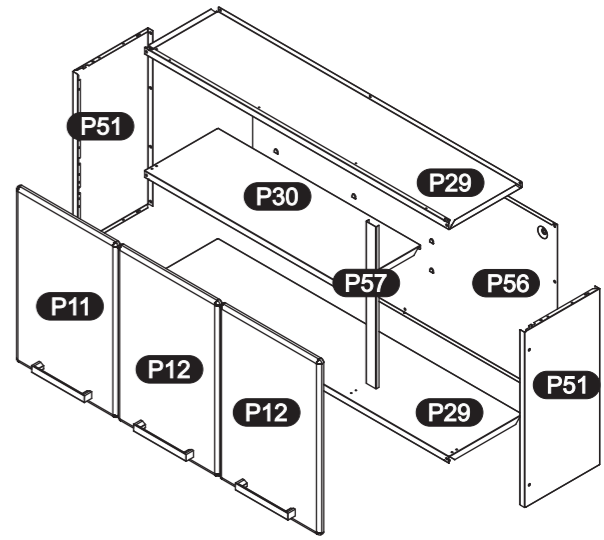

Ref:
 6009 - 6010
 7008 - 7009

14

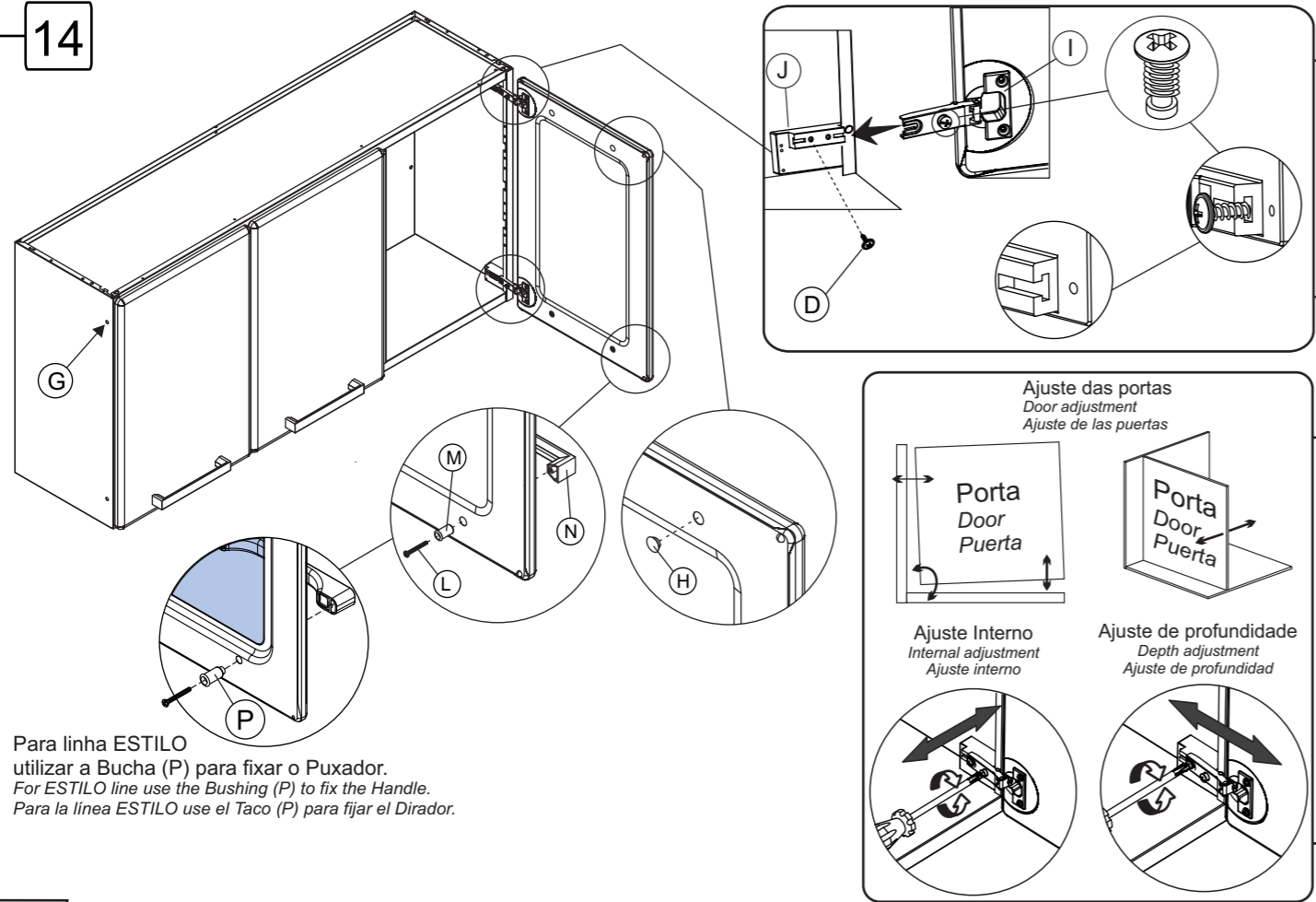

Para linha ESTILO utilizar a Bucha (P) para fixar o Puxador.
 For ESTILO line use the Bushing (P) to fix the Handle.
 Para la línea ESTILO use el Taco (P) para fijar el Dirador.

Bertolini Bertolini Bertolini Bertolini

Acessórios Hardware Accesorios	Quantidade Quantity Cantidad	Acessórios Hardware Accesorios	Quantidade Quantity Cantidad
A	02	L	06
B	02	M	06
C	12	N	03
D	24	O	06
E	12	P	06
F	12		
G	08		
H	06		
I	06		
J	06		
K	06		

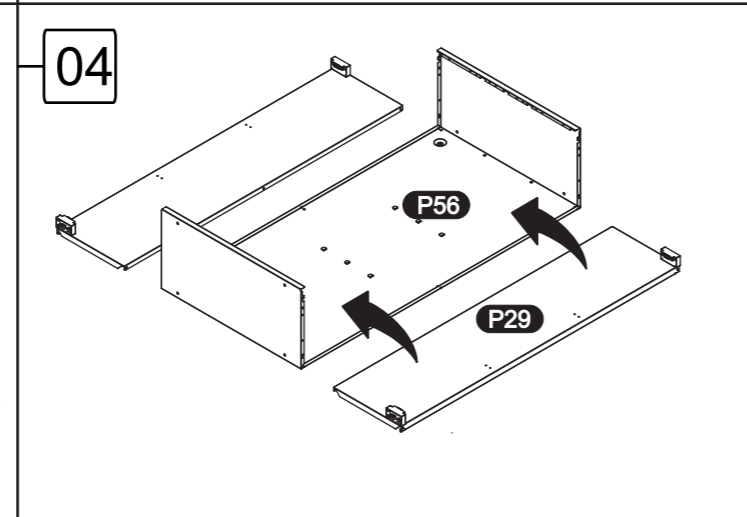
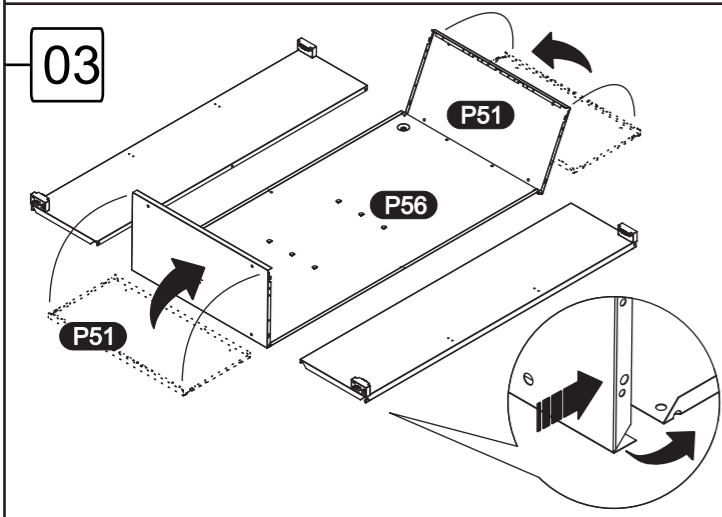
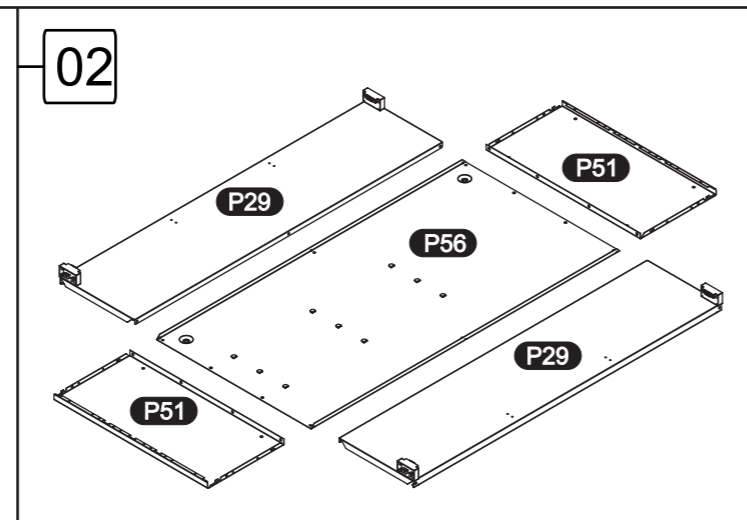
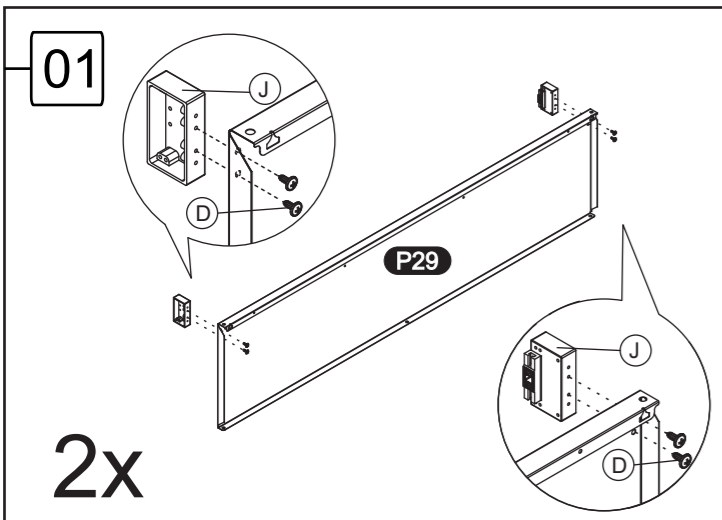

Bertolini Bertolini Bertolini Bertolini

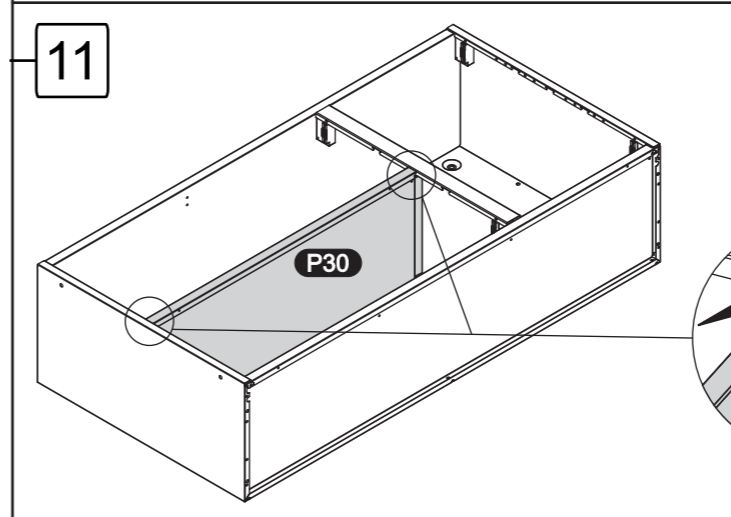
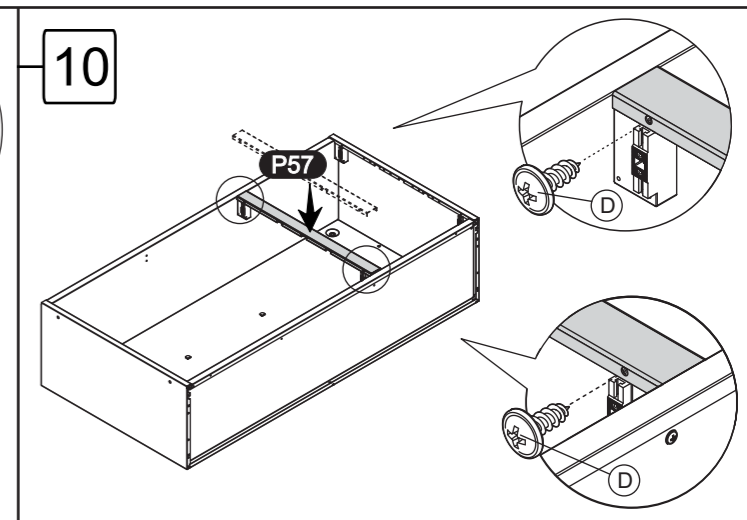
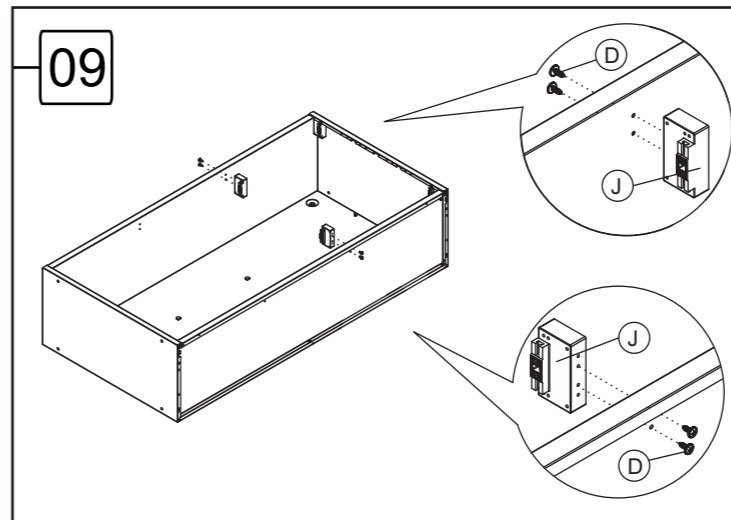
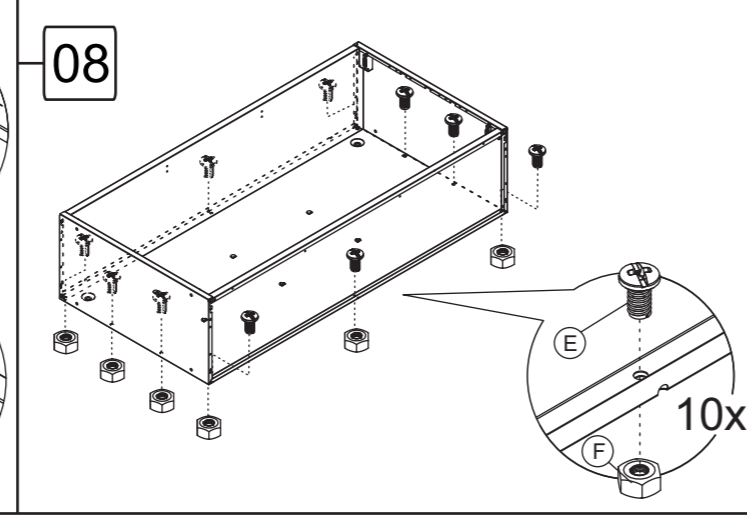
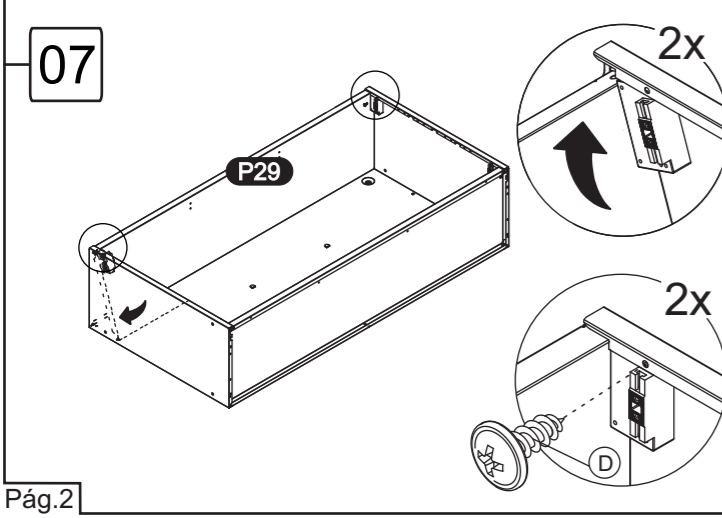
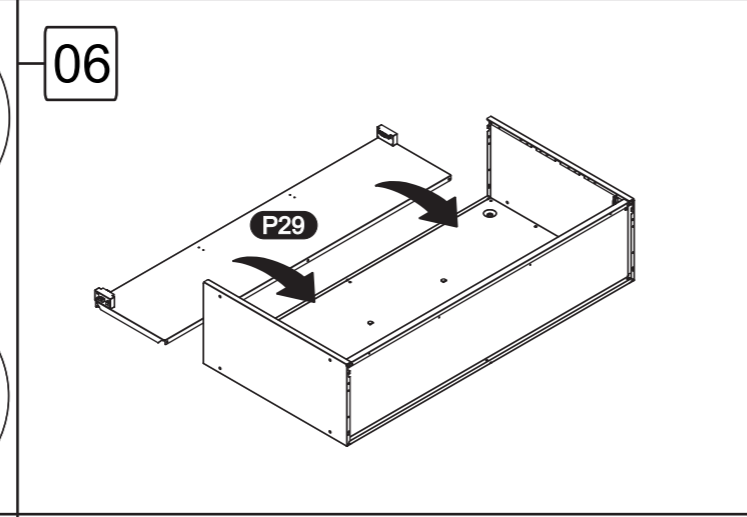
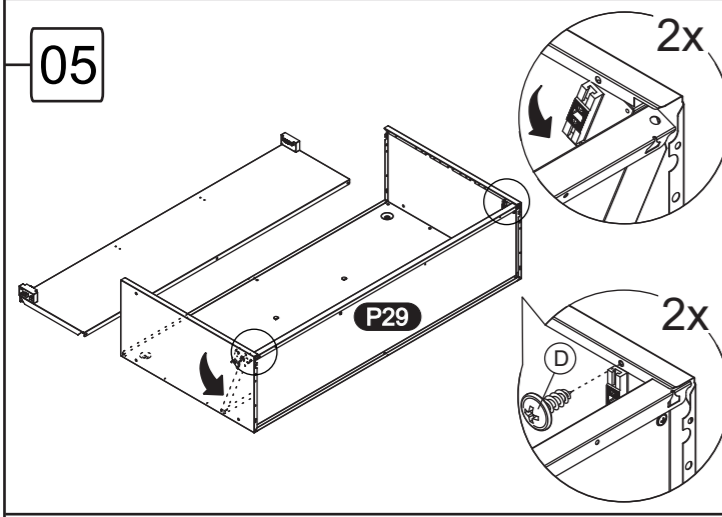

Siga os passos de montagem
Follow the assembly steps
Siga las etapas de ensamblaje

Bertolini Bertolini Bertolini Bertolini

Bertolini Bertolini Bertolini Bertolini

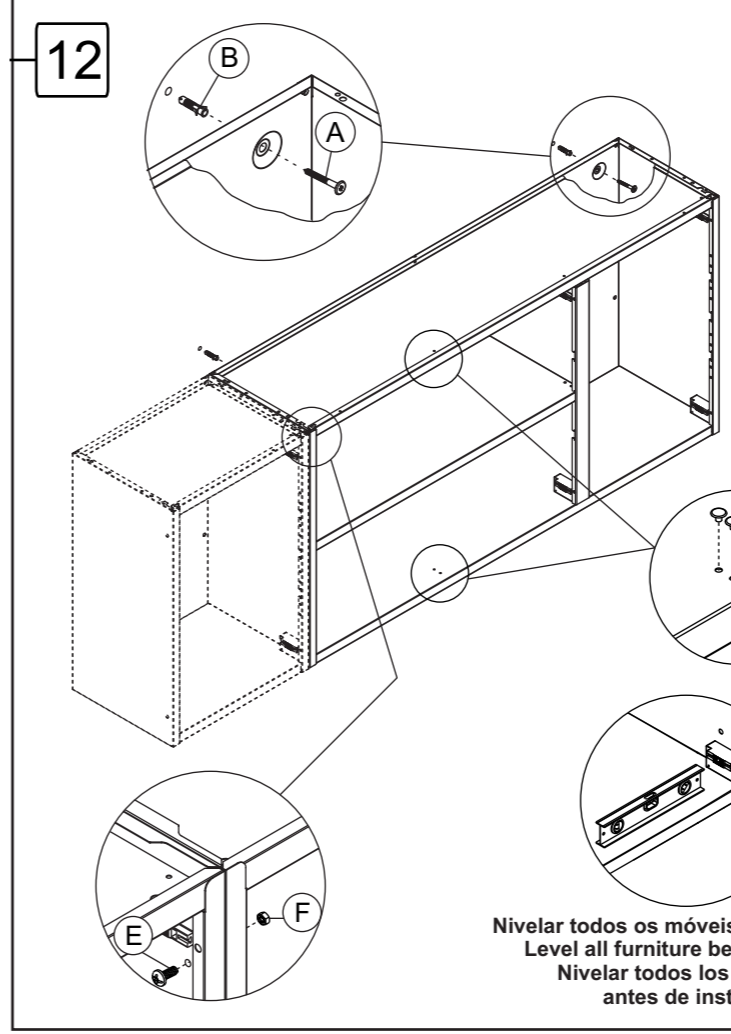
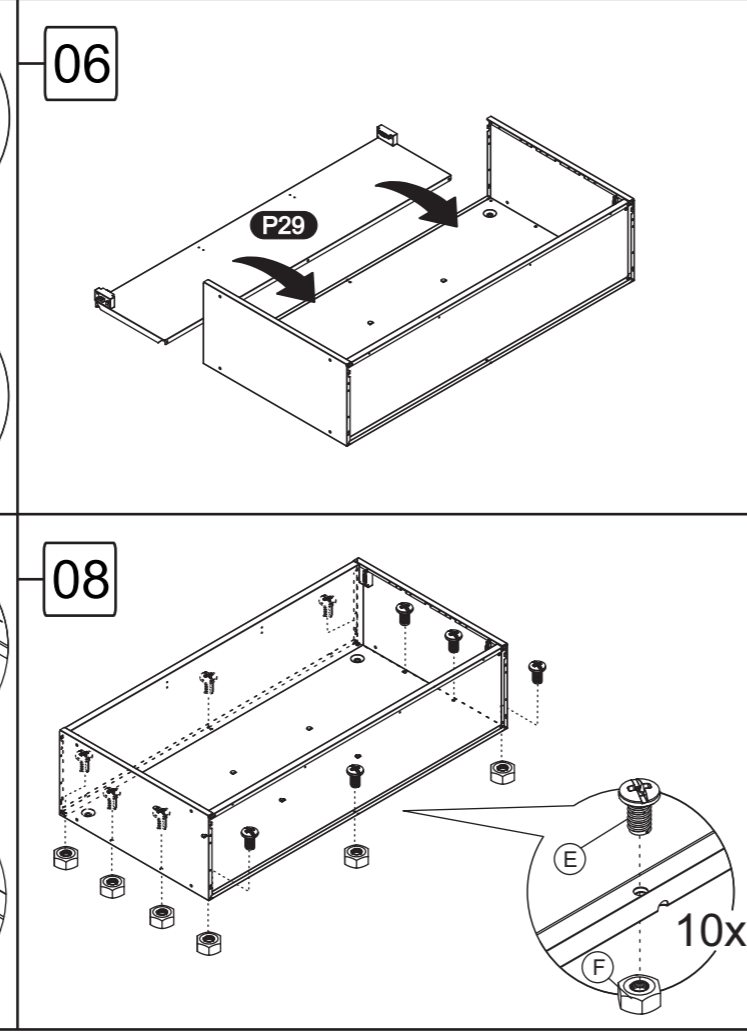
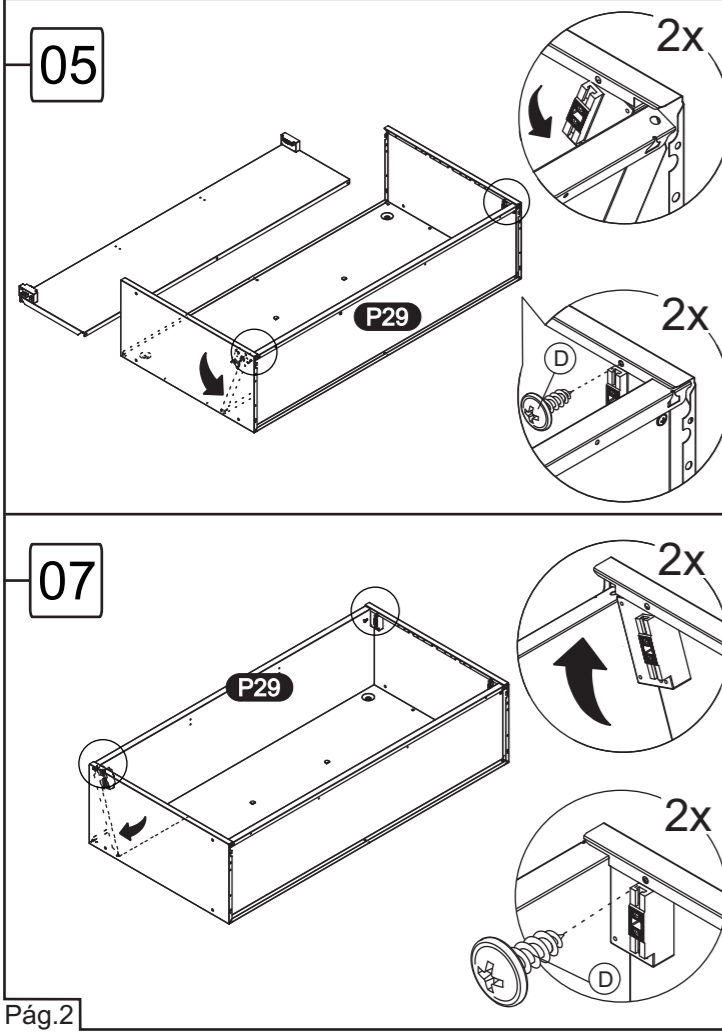

Fixação na Parede
Fastening to the wall
Fijación a la pared

IMPORTANTE:
Para sua segurança, fixe o móvel na parede com o acessório fornecido pela Bertolini.
OBS.: A Bertolini não se responsabilizará por acidentes decorrentes da não observância desta norma e pela fragilidade da parede.

IMPORTANT:
For your safety, fasten the cabinet to the wall with the accessory furnished by Bertolini. **NOTE.:** Bertolini will not be responsible for accidents resulting from non observing this norm or by the weakness of the wall.

IMPORTANTE:
Para su seguridad, fije el mueble en la pared con el accesorio suministrado por Bertolini. **OBS.:** Bertolini no se responsabilizará por accidentes ocasionados por la inobservancia de esta norma y por la fragilidad de la pared.

Nivelar todos os móveis antes de fixar.
Level all furniture before setting.
Nivelar todos los muebles antes de instalar.